

All our meeting rooms have been purpose built – they are soundproofed and air conditioned and all have natural light.

Conference Porters and Audio Visual Technicians are always available, and can be contacted via the Events Office or Reception.

The Combined Conference Room (and Conference Room 1 when used as a separate room) has a large screen (3.8 x 1.8m) with back projection, and a built-in sound system. There is a Crestron touchscreen control system enabling presenters to switch from Powerpoint to DVD and to control volume. The Crestron system is duplicated in Conference Room 2.

All Training Rooms (and Conference Room 2 when used as a separate room) are equipped with a mobile AV cabinet containing LCD projector, DVD/video player and speakers. Each room also has a screen, wall-mounted and free-standing flip-charts. (OHP's are also available if required). All Training Room walls are magnetic.

Syndicate Rooms have a wall-mounted flip chart, and the two long walls in each room are magnetic.

Broadband internet access is available, via a wireless network, throughout the training area and in the lounge/bar, dining areas and courtyards. Plug-in ISDN connections are available in every bedroom.

The Business Centre, open 24 hours a day, offers PCs with Broadband connection, Microsoft Office software, printers, and colour photocopier.



WybostonLakes
Conference and Training

Robinson Executive Centre
Sales: 0845 2300 666 / sales@wybostonlakes.co.uk
Reception: 01480 226300 www.robinsonexec.com

ROBINSON EXE

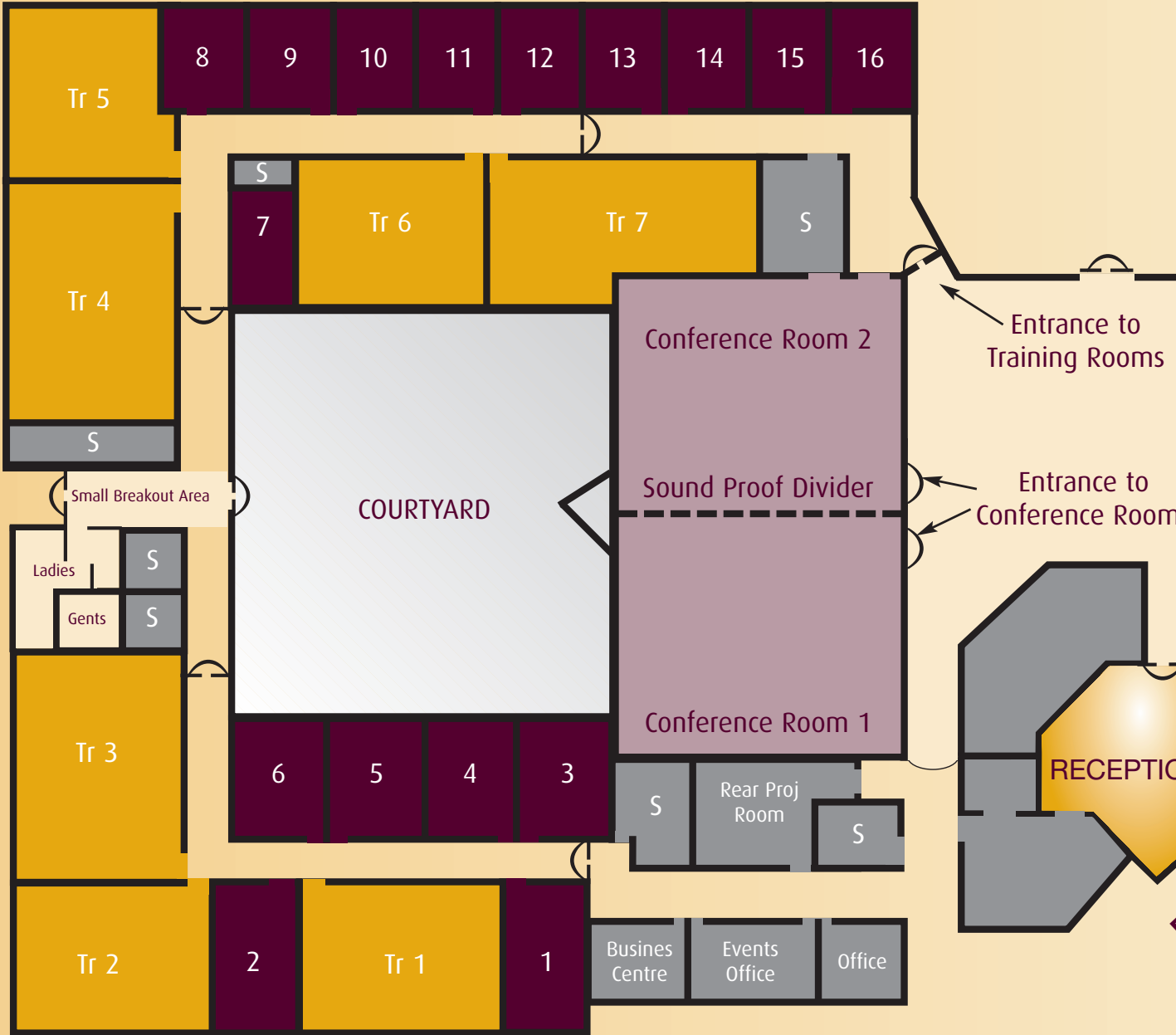

EXECUTIVE CENTRE

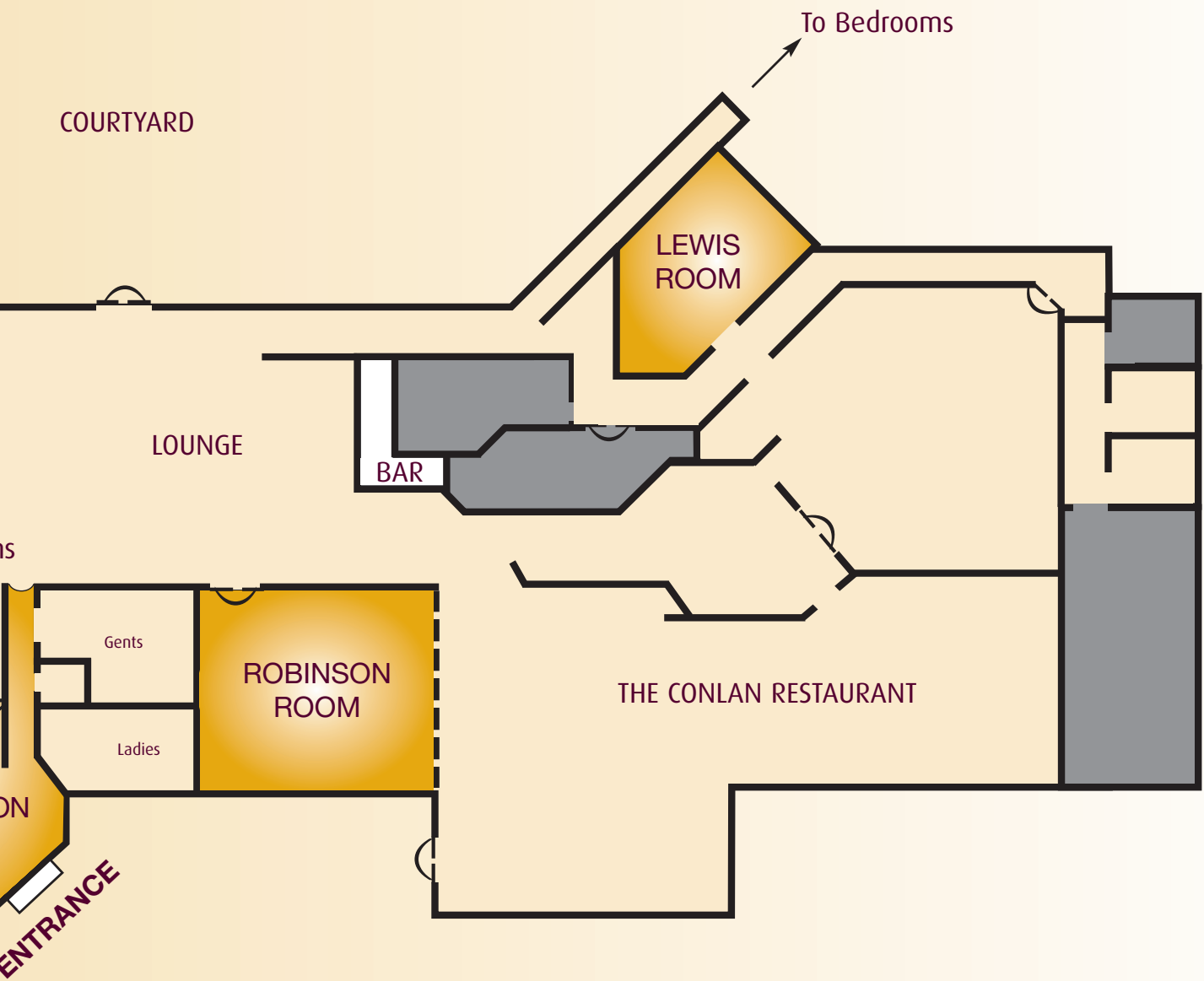

-  Offices & Stores
-  Conference Rooms
-  Training Rooms
-  Syndicate Rooms
-  Dining & Social Areas

MAIN BUILDING

GENERAL INFORMATION

Ceiling Height 3m/12ft

Room Capacities

ROOM No.	Dimensions	Area m ² /ft ²	Cabaret	Horse- shoe	Theatre Style	U-Shape	Board- room	Class Room	Banquet
Conference Room 1	10m x 12m 39ft x 33ft	120 1287	56	39	100	34	40	56	-
Conference Room 2	10m x 12m 39ft x 33ft	120 1287	56	39	100	34	40	56	-
Combined Conference	12m x 20m 39ft x 66ft	240 2574	150 (round)	84	240	58	64	120	-
Training Room 1	8.4m x 6m 28ft x 20ft	50 520	24	23	50	17	25	28	-
Training Room 2	7.6m x 6m 25ft x 20ft	50 500	24	23	50	17	25	28	-
Training Room 3	9.8m x 7.1m 32ft x 23ft	70 736	32	33	50	24	34	30	-
Training Room 4	10.5m x 7.1m 34ft x 23ft	75 782	32	33	50	24	34	30	-
Training Room 5	7.4m x 6.5m 24ft x 21ft	48 504	24	23	50	17	25	28	-
Training Room 6	7.7m x 6.5m 25ft x 21ft	50 525	24	23	50	17	25	28	-
Training Room 7	6.5m x 11.8m 21ft x 39ft	70 819	32	32	60	24	24	41	-
Syndicate Rooms 1-2	3.6m x 6m 12ft x 20ft	22 240	-	12	15	-	14	-	-
Syndicate Rooms 3-6	3.9m x 5m 13ft x 17ft	20 221	-	12	15	-	12	-	-
Syndicate Room 7	3m x 4.95m 10ft x 17ft	15 160	-	8	-	-	6	-	-
Syndicate Rooms 8-16	3.3m x 4.5m 11ft x 15ft	15 165	-	9	10	-	6	-	-
Robinson Room	8.5m x 10m 27ft x 33ft	85 891	40	32	80	27	34	40	50
The Conlan Restaurant	(11m x 14m) +(9m x 14m) (36ft x 46ft) +(29ft x 46ft)	270 3980	-	-	-	-	-	-	240
Lewis Room	5.6m x 6.6m 18ft x 21.5ft	36 386	-	-	-	-	18	-	18